

# PORTABLE SOLAR SYSTEM 1000W/1500W

Solar Panel Energy (Pty) Ltd  
 204 Louis Trichardt Blvd, Vanderbijlpark  
 SE7  
 Vanderbijlpark  
 inquiry@solarpanelenergy.co.za  
 www.solarpanelenergy.co.za



## 1 Product features

### Product Features

- Excellent performance because of double CPU intelligent control technology;
- A wide range of applicable loads because of pure sine wave AC output
- The mains supply mode/energy-saving mode/battery mode can be set for flexible
- Convenient and practical 5VDC-USB output port and 12VDC output port;
- Digital LCD and LEDs for visualization of operation status of the equipment
- Overcharge protection and over discharge protection for a longer battery life;
- Safe and reliable with intelligent exhaust fan control
- Overall automatic protection and alarms including AC output overload protection, short circuit protection, etc.

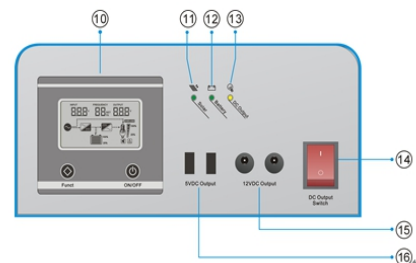
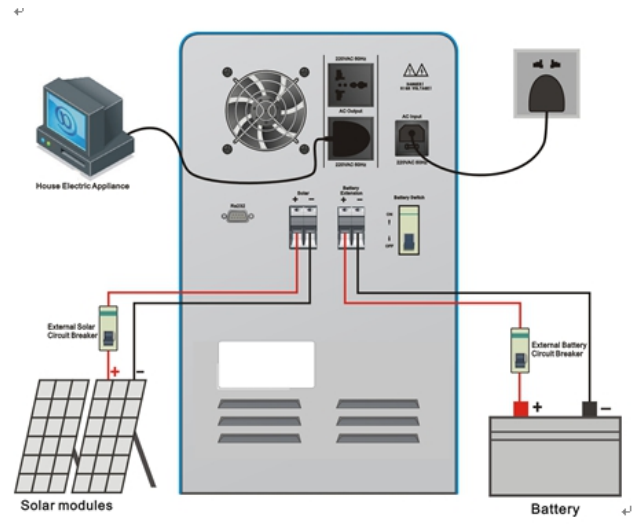
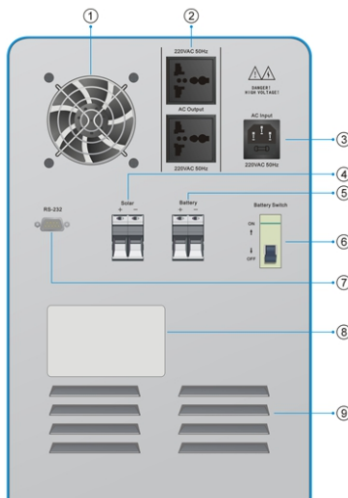

Instructions:↵

- ⑩-- Inverter LCD display / operation interface↵
- ⑪--Solar: Solar input state indicator↵
- ⑫--Battery: Battery mode indicator ↵
- ⑬--DC Output: 5VDC-USB, 12VDC output indicator↵
- ⑭--5VDC-USB, 12VDC output ON/OFF switch↵
- ⑮--12VDC Output: 12VDC output terminal↵
- ⑯--5VDC Output: 5VDC-USB output terminal↵

- 1--Fan:
- 2--AC Output (Max. 10A)
- 3--AC Input:
- 4--Solar:Solar module input terminals
- 5--Battery:External battery input terminals(selectable)
- 6--Battery Switch:built-in battery switch
- 7--RS232communication port
- 8--Model stickers
- 9--Heat dissipation window

# TECHNICAL DATA

Model		BT-1000W		BT-1000S	BT-1500W
Battery rated voltage ( VDC)		12	24	24	24
Inverter	Rated power ( W)	1000W		1000W	1500W
	Input voltage range ( VAC)	160-275VAC			
	Input frequency ( Hz)	45Hz-65Hz			
	Output voltage ( VAC)	110VAC/220VAC			
	Output frequency ( Hz)	50Hz/60Hz			
	Output wave	Pure Sine Wave			
	Specification of built-in battery	1* 100AH/12V	2*55 AH/12V	2* 100AH/12V	2* 100AH/12V
	Communication	RS232			
Solar input	Max. PV voltage ( VDC)	≤ 25	≤ 50		
	Range of charging voltage ( VDC)	10-25	20-50		
	Controller rated charge current ( A)	PWM 30A			
	Voltage for overcharge protection ( VDC)	14.2	14.2	28.4	
	Voltage for overcharge recovery ( VDC)	14.0	14.0	28.0	
	Solar input power range	150W/180W two pcs in parallel	270W/300W two pcs in parallel		270W/300W two pcs in parallel
DC output	Voltage for high voltage protection ( VDC)	16V	32V	32V	
	High voltage recovery voltage ( VDC)	15.2V	30.4	30.4	
	Low voltage recovery voltage ( VDC)	12.6V	25.2	25.2	
	Low voltage protection voltage ( VDC)	11	22	22	
	5VDC USB output	2units /MAX 2A			
	12VDC output ports	2units/MAX 2A			
Heat dissipation/Cooling		Temperature control by intelligent exhaust fan			
Operating ambient temperature		-20 - +50 °C			
Storage ambient temperature		-25 - +55 °C			
Operating/Storage ambient		0-90% No condensation			
External size : W*D*H ( mm )		423×260×453	513 × 310 × 493		
Package size : W*D*H ( mm )		520×370×520	610 × 420 × 550		